

**WILWOOD** **RACING**  
ESTABLISHED 1977

THE MOST **WIDELY USED BRAKES** IN ALL MOTORSPORTS

**NE DIRT  
MODIFIED  
2026 PRODUCT CATALOG**

**wilwoodracing.com**

## NE Dirt Modified – We've Got You Covered!

Since 1977, Wilwood Engineering has been at the forefront of high-performance disc brake technology and is the most widely used brake brand in motorsports. Located in Camarillo, California, Wilwood is proud to be an American manufacturer that designs and builds all its products locally. Our engineering department uses the latest computer-aided design and manufacturing techniques with finite element analysis (FEA), dynamic testing, and cycle test equipment to find higher performance and more reliable solutions to the most difficult braking tasks, racing. Our extensive inventory of proprietary on-the-shelf components permits us to provide very cost-effective solutions to various needs. We have developed a substantial matrix of brake components and engineering techniques that allow us to quickly and reliably create brake systems for almost any application.

This catalog represents a fraction of what we offer, and we're constantly adding new items. Our complete product line may be browsed on our website, [www.wilwoodracing.com](http://www.wilwoodracing.com), which is the most comprehensive within the racing and performance aftermarket industries. Searching for parts is simple, and if you can't find what you're looking for, **please contact:**



### Your Wilwood Race Support Professionals

**DAVE BRZOZOWSKI**  
 Motorsports Manager  
 (805) 388-1188 ext. 311  
[dbrzozowski@wilwood.com](mailto:dbrzozowski@wilwood.com)

**DISCLAIMER:** Wilwood engineers brake kits and components for a wide variety of racing and high performance driving applications. It is the responsibility of the end user to choose the parts that are best suited for the braking demands encountered by his or her vehicle. Vehicle speed and weight, along with environmental conditions should always be taken into account when selecting and installing the kit or component that's right for you.

# CALIPERS



**Forged Narrow Dynalite**  
 Pad Plate No. **7816**

**0.38" Rotor Width**  
**120-11571-SI**  
 1.75" Piston Dia.

**0.81" Rotor Width**  
**120-11572-SI**  
 1.75" Piston Dia.



**Forged Superlite 4 Radial Mount**  
 Pad Plate No. **7420**

**0.81" Rotor Width**  
**120-13826 (R)**  
**120-13827 (L)**  
 1.88/1.75" Piston Dia.  
**120-13828 (R)**  
**120-13829 (L)**

**Thermlock Pistons**  
 1.88/1.75" Piston Dia.

**1.25" Rotor Width**  
**120-13263 (R)**  
**120-13264 (L)**

**Thermlock Pistons**  
 1.88/1.75" Piston Dia.



**XRZ4R Radial Mount**  
 Pad Plate No. **10420**

**0.81" Rotor Width**  
**Z-120-16462 (R)**  
**Z-120-16463 (L)**

**Thermlock Pistons**  
 1.88/1.75" Piston Dia.



**Forged Superlite Internal**  
 Pad Plate No. **7420**

**0.81" Rotor Width**  
**120-11134**  
 1.75" Piston Dia.

**120-11137 (R)**  
**120-11138 (L)**  
 1.88/1.75" Piston Dia.



**Powerlite Radial Mount**  
 Pad Plate No. **7912**

**0.50" Rotor Width**  
**120-8724**  
 1.00" Piston Dia.  
**120-8725**  
 1.25" Piston Dia.  
**120-15734**

**0.86" Rotor Width**  
**120-8727**  
 1.00" Piston Dia.

**120-8728**  
 1.25" Piston Dia.  
**120-8729**  
 1.38" Piston Dia.



**DynaPro Lug Mount**  
 Pad Plate No. **7812**

**0.38" Rotor Width**  
**120-9705-SI**  
 1.38" Piston Dia.  
**120-9695-SI**  
 1.75" Piston Dia.



**DynaPro Single**  
 Pad Plate No. **6812**

**0.38" Rotor Width**  
**120-9690**  
 1.38" Piston Dia.  
**120-9689**  
 1.75" Piston Dia.



**Billet NDLR Mount**  
 Pad Plate No. **7816**

**0.38" Rotor Width**  
**120-13405-SI**  
 1.75" Piston Dia.  
**120-14764-SI**  
 1.88" Piston Dia.

**0.81" Rotor Width**  
**120-13406-SI**  
 1.75" Piston Dia.  
**120-14765-SI**  
 1.88" Piston Dia.

**CALIPER PARTS, FITTINGS, HARDWARE AND ACCESSORIES ALSO AVAILABLE.**

**VISIT OUR RACING WEBSITE**  
[WILWOODRACING.COM](http://WILWOODRACING.COM)

### RACING CALIPER MOUNTING BRACKET

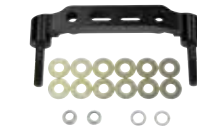

**250-6309**  
 For FSL4R Calipers.  
 Designed for any 3.50" mount center.



**250-9656**  
 For Powerlite Calipers.  
 Designed for any 3.75" mount center.

**250-14313**  
 Dynapro Single Calipers  
 Mount Winters LW Spindle  
 11.75" Dia. Rotors Only



**250-14767**  
 For Billet NDLR Calipers  
 with 3.5" mount centers



**250-14315**  
 For Powerlight Calipers  
 Mount Winters LW Spindle  
 11.75" Dia. Rotors Only

*Can't find what you're looking for?*

**Contact**  
**Dave**

**Brzozowski**  
 (805) 388-1188 x311

*or email*  
[dbrzozowski@wilwood.com](mailto:dbrzozowski@wilwood.com)

# ROTORS

## IRON

Bolt Circle:  
8 x 7.00



**Ultralite 32 Vane**  
**160-0471** 11.75" Dia.  
**160-0277** 12.19" Dia.  
0.81" Width



**Ultralite HP 32 Vane**  
**160-5841** 11.75" Dia.  
**160-5843** 12.19" Dia.  
0.81" Width

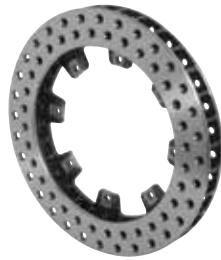

**Ultralite 32 Vane**  
**160-5863** 11.75" Dia.  
**160-5865** 12.19" Dia.  
0.81" Width



**Ultralite 32 Vane**  
**160-8135** 11.75" Dia.  
**160-8136** 12.19" Dia.  
0.81" Width

## SPEC-37



**GT 40 Straight Vane  
Dynamic Lug Mount**  
**160-16923**  
**160-16923-B**  
0.81" Width  
Bolt Circle: 8 x 7.18L



**GT 36 Curved Vane**  
**160-12291 (R)**  
**160-12292 (L)**  
0.81" Width  
12.19" Diameter  
Bolt Circle: 8 x 7.00

## SPEC-37

Bolt Circle:  
8 x 7.00



**HD 36 Curved Vane**  
**160-16869 (R)**  
**160-16870 (L)**  
0.81" Width  
11.75" Diameter



**GT 36 Curved Vane**  
**160-12285 (R)**  
**160-12286 (L)**  
**160-12285-B (R)**  
**160-12286-B (L)**  
0.81" Width  
11.75" Diameter

## SUPER ALLOY

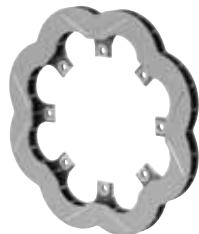

**160-17781** 0.81" Width  
**160-15840** 1.25" Width  
11.75" Diameter  
Bolt Circle: 8 x 7.00

NE DIRT MODIFIED

# ROTORS

## STEEL

Bolt Circle:  
3 x 5.00



**160-2084**  
0.31" Width  
10.95" Diameter

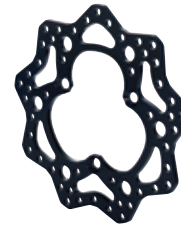

**160-10475**  
0.31" Width  
11.00" Diameter

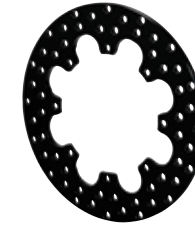

**160-3202**  
0.35" Width  
11.75" Diameter



**160-5855**  
0.35" Width  
11.75" Diameter

## ROTOR BOLT KITS



**230-14845**



**230-8390**  
Lock Wire Drilled (LWD)

## WIDE 5 STARLITE 55XD HUB



**270-18422C (Rear)**  
1 Ton Bearing Races  
Coarse Wheel Studs

**230-18380**  
Drive Flange  
Stud Kit

**230-18022**  
1 Ton Locknut Kit

**370-16729**  
1 Ton Bearing & Seal Kit

**230-16183**  
Starlite 55 5-bolt  
Camber Drive Flange 2-Deg

NE DIRT MODIFIED

## STEEL

Bolt Circle:  
8 x 7.00



**160-9772** 11.75" Dia.  
**160-9773** 12.19" Dia.  
0.35" Width

## ROTOR ADAPTERS

**300-13474**  
Winters  
LW Hub

**300-14294**  
Zero Offset for  
Wide 5 hubs

**300-16921**  
Dynamic  
Lug Mount  
Rotor Adapter  
Wide 5 Hubs

**300-12561**  
Dynamic Lug  
Rotor Mounting  
and Snap Ring Kit

**230-17419**  
Dynamic Lug Mount  
Plate Bolt Kit  
Wide 5 Hubs

ROTORS | 5

# MASTER CYLINDERS



**Compact Remote Flange Mount Master Cylinder with Plastic Reservoir**

- 260-10371** 5/8"
- 260-10372** 3/4"
- 260-10373** 13/16"
- 260-10374** 7/8"
- 260-14784** 15/16"
- 260-10375** 1.00"
- 260-10376** 1-1/8"



**Compact Remote Flange Mount Master Cylinder Banjo Outlet with Plastic Reservoir**

- 260-13618** 5/8"
- 260-13619** 3/4"
- 260-13620** 13/16"
- 260-13621** 7/8"
- 260-14787** 15/16"
- 260-13622** 1.00"
- 260-13623** 1-1/8"



**No-Bleed Quick Disconnect Fitting**  
Dry Break Quick Connect/Disconnect -3 AN Fittings

- 260-16771** Kit
- 260-16770** Female
- 260-16769** Male



**Lightweight Reservoir Kit**  
**260-16392** Remote Mount



- Billet Reservoir Bracket**
- 250-16872** Single
  - 250-16393** Dual
  - 250-16874** Triple



**260-8419**  
**Knob Proportioning Valve**



**260-8420**  
**Lever Proportioning Valve**



**260-9921**  
**Shutoff Valve**



**Brake Fluids and Brake Bleed Bottle**

- 290-16353** XR Race-Only
- 290-6209** EXP 600 Plus
- 290-0632** HI-TEMP 570
- 260-16018** Bleed Bottle

**FOR MORE BRAKE PAD INFORMATION, VISIT**  
[WWW.WILWOODRACING.COM](http://WWW.WILWOODRACING.COM)

## PEDALS ACCESSORIES



**60 Degree Mount Pedal**  
**340-4630**



**60 Degree Mount Tru-Bar Pedal**  
**340-14380**



**Pedal Kit, Tru-Bar Brake**  
**340-14479**



**Rod Ends & Spacer Kit**  
**340-15595**

**Spacer**  
**300-18280**



**Brake Pressure Gauge**  
**260-0966**

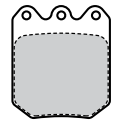

- Pad Plate No. 6812**
- 150-45-6812K** BP-45
  - 150-40-6812K** BP-40
  - 150-28-6812K** BP-28
  - 150-20-6812K** BP-20

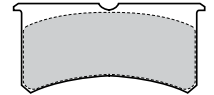

- Pad Plate No. 7420**
- 150-45-7420K** BP-45
  - 150-40-7420K** BP-40
  - 150-35-7420K** BP-35
  - 150-30-7420K** BP-30
  - 150-28-7420K** BP-28
  - 150-20-7420K** BP-20

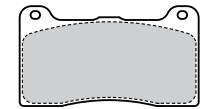

- Pad Plate No. 7816**
- 150-45-7816K** BP-45
  - 150-40-7816K** BP-40
  - 150-35-7816K** BP-35
  - 150-30-7816K** BP-30
  - 150-28-7816K** BP-28
  - 150-20-7816K** BP-20

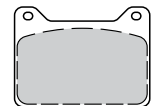

- Pad Plate No. 7912**
- 150-45-7912K** BP-45
  - 150-40-7912K** BP-40
  - 150-30-7816K** BP-30
  - 150-28-7816K** BP-28
  - 150-20-7816K** BP-20

*Can't find what you're looking for?*

*For more information and technical questions, contact:*

**Dave Brzozowski - (805) 388-1188 x311 - dbrzozowski@wilwood.com**

**DISCLAIMER:** Wilwood engineers brake kits and components for a wide variety of racing and high performance driving applications. It is the responsibility of the end user to choose the parts that are best suited for the braking demands encountered by his or her vehicle. Vehicle speed and weight, along with environmental conditions should always be taken into account when selecting and installing the kit or component that's right for you.

# NOTES



P/N: CAT-NEDM | Rev. 02/26/2026



| BRAKE KITS | CALIPERS | ROTORS | MASTER CYLINDERS | PEDALS | PRESSURE VALVES | HATS | BRAKE FLUID |  
| BRAKE PADS | HUBS | PROSPINDLES | BRAKE LINES | FLEXLINES | PARKING BRAKES | HARDWARE |

SCAN & EXPLORE



**RACING**  
**wilwood**  
ESTABLISHED 1977

805.388.1188 | [wilwoodracing.com](http://wilwoodracing.com) |     