

WILWOOD **RACING**

ESTABLISHED 1977

THE MOST **WIDELY USED BRAKES** IN ALL MOTORSPORTS

DIRT **LATE MODEL** **PRODUCT CATALOG**



wilwoodracing.com



Dirt Late Model – We’ve Got You Covered!

The 1960’s are popularly considered as the beginning of modern dirt late model racing. From those early days of backyard and garage modified production frame cars, today’s dirt late model has evolved into one of the most highly specialized and sophisticated forms of racing machines. While most dirt late models all carry a common theme, variations in local, regional, and sanctioning body rules have created a need for brake systems and components as specialized as the cars and drivers themselves.

Since 1977, Wilwood Engineering has been at the forefront of high-performance disc brake technology and is the most widely used brake brand in motorsports. Located in Camarillo, California, Wilwood is proud to be an American manufacturer that designs and builds all its products locally. Our engineering department uses the latest computer-aided design and manufacturing techniques with finite element analysis (FEA), dynamic testing, and cycle test equipment to find higher performance and more reliable solutions to the most difficult braking tasks, racing. Our extensive inventory of proprietary on-the-shelf components permits us to provide very cost-effective solutions to various needs. We have developed a substantial matrix of brake components and engineering techniques that allow us to quickly and reliably create brake systems for almost any application.



This catalog represents a fraction of what we offer, and we’re constantly adding new items. Our complete product line may be browsed on our website, www.wilwoodracing.com, which is the most comprehensive within the racing and performance aftermarket industries. Searching for parts is simple, and if you can’t find what you’re looking for, **please contact:**

Your Wilwood Race Support Professionals

DAVE BRZOZOWSKI
Motorsports Manager
(805) 388-1188 ext. 311
dbrzowski@wilwood.com

JIM “SPIKE” LOGUE
Dirt Late Model
(805) 384-4191
jlogue@wilwood.com

DISCLAIMER: Wilwood engineers brake kits and components for a wide variety of racing and high performance driving applications. It is the responsibility of the end user to choose the parts that are best suited for the braking demands encountered by his or her vehicle. Vehicle speed and weight, along with environmental conditions should always be taken into account when selecting and installing the kit or component that’s right for you.

CALIPERS



Forged Narrow Dynalite
Pad Plate No. **7816**

0.38" Rotor Width

- 120-11577**
- 1.12 Piston Dia. **120-11574**
- 1.38" Piston Dia. **120-14330**
- 1.62" Piston Dia. **120-11571**
- 1.75" Piston Dia.

0.81" Rotor Width

- 120-11578**
- 1.12" Piston Dia. **120-11575**
- 1.38" Piston Dia. **120-14331**
- 1.62" Piston Dia. **120-11572**
- 1.75" Piston Dia.

1.00" Rotor Width

- 120-15255**
- 1.38 Piston Dia. **120-14332**
- 1.62" Piston Dia. **120-15254**
- 1.75" Piston Dia.

1.25" Rotor Width

- 120-11579**
- 1.12" Piston Dia. **120-11576**
- 1.38" Piston Dia. **120-14333**
- 1.62" Piston Dia. **120-11573**
- 1.75" Piston Dia.



Forged Superlite Internal
Pad Plate No. **7420**

0.81" Rotor Width

- 120-11125**
- 1.12 Piston Dia. **120-11126**
- 1.25 Piston Dia. **120-11128**
- 1.38 Piston Dia. **120-11131**
- 1.62 Piston Dia. **120-11134**
- 1.75 Piston Dia. **120-11137 (R)**
- 120-11138 (L)**
- 1.88/1.75" Piston Dia.

1.10" Rotor Width

- 120-11129**
- 1.38 Piston Dia. **120-11132**
- 1.62 Piston Dia. **120-11135**
- 1.75 Piston Dia.

1.25" Rotor Width

- 120-11127**
- 1.25 Piston Dia. **120-11130**
- 1.38 Piston Dia. **120-11133**
- 1.62 Piston Dia. **120-11136**
- 1.75 Piston Dia. **120-11329 (R)**
- 120-11330 (L)**
- 1.88/1.75" Piston Dia.



Billet NDLR Mount
Pad Plate No. **7816**

0.81 Rotor Width

- Z-120-15563-SI**
- 1.38" Piston Dia. **120-15565-SI**
- 1.62" Piston Dia. **120-13406-SI**
- 1.75" Piston Dia. **120-14765-SI**
- 1.88" Rotor Width

1.00 Rotor Width

- 120-15564-SI**
- 1.38" Piston Dia. **120-15566-SI**
- 1.62" Piston Dia. **120-15567-SI**
- 1.75" Piston Dia. **120-15568-SI**
- 1.88" Piston Dia.



FSL4R Radial Mount
Pad Plate No. **7420**

0.81" Rotor Width

- 120-13234**
- 1.12 Piston Dia. **120-13233**
- 1.25 Piston Dia. **Z-120-13826 (R)**
- Z-120-13827 (L)**
- 1.88/1.75" Piston Dia.

**CALIPER PARTS,
FITTINGS, HARDWARE
AND ACCESSORIES
ALSO AVAILABLE.**

**VISIT OUR
RACING WEBSITE
WILWOODRACING.COM**

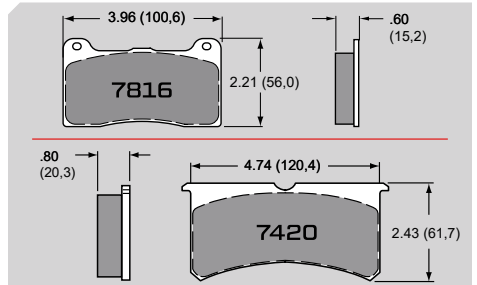

RACING CALIPER MOUNTING BRACKET



250-6309
For FSL4R Calipers.
Designed for any
3.50" mount center.

250-14767
For Billet NDLR Calipers
with 4.75" center to
center radial mount



**Can't find what your looking for? Contact
Jim "Spike" Logue (805) 384-4191
or email jlogue@wilwood.com**

ROTORS

SPEC-37

11.75 Diameter | Bolt Circle: 8 x 7.00



GT 36 Curved Vane

160-12285 (R)

160-12286 (L)

0.81" Width



ULHD 16 Curved Vane

160-15877 (R)

160-15878 (L)

0.99" Width



HD 48 Curved Vane

160-13497 (R)

160-13498 (L)

1.21" Width



HD 36 Curved Vane

160-12283 (R)

160-12284 (L)

0.81" Width



ULGT 16 Curved Vane

160-15879 (R)

160-15880 (L)

0.99" Width



**GT 40 Straight Vane
Dynamic Lug Mount**

160-16923

0.81" Width



HD 36 Curved Vane

160-16869 (R)

160-16870 (L)

0.81" Width



GT 48 Curved Vane

160-13499 (R)

160-13500 (L)

1.21" Width

ROTOR BOLT KITS



230-0526



230-2589

Lock Wire Drilled (LWD)

ROTORS

11.75 Diameter | Bolt Circle: 8 x 7.00

IRON

SUPER ALLOY



Ultralite 32 Vane
160-0471
 0.81" Width



Ultralite 32 Vane
160-5863 0.81" Width
160-5864 1.25" Width

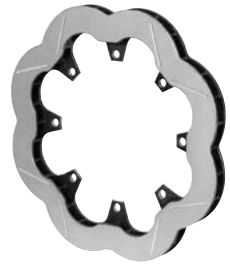

160-13373 0.81" Width
160-15840 1.25" Width
 11.75 Diameter

STEEL



Ultralite 32 Vane
160-0483
 1.25" Width

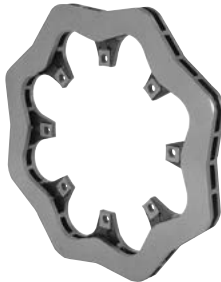

Ultralite 32 Vane
160-8135
 0.81" Width



160-9772
 0.35" Width
 11.75 Diameter

ROTOR ADAPTERS



Ultralite 32 Curved Vane
160-2898 (R)
160-2899 (L)
 1.25" Width



Ultralite 32 Vane
160-8343 5.8 lbs
160-8814 6.4 lbs
 1.25" Width



300-11211
 Replacement Starlite XD55
 5x4.50 BC



300-14294
 Zero Offset for
 Wide 5 hubs



230-14845

For technical questions and more information, contact:
 Jim "Spike" Logue (805) 384-4191 - jlogue@wilwood.com



270-16772BD (R)

1 Ton Bearing Races
Drilled Coarse Wheel Studs

270-6513BC (R)

Coarse Wheel Studs

270-6513BD (R)

Drilled Coarse Wheel Studs



270-16772BLS (R)

1 Ton Bearing Races
Long Coarse Studs

270-6513BLS (R)

Long Coarse Studs



270-16772LS (R)

1 Ton Bearing Races
Long Coarse Studs

270-6513LS (R)

Long Coarse Studs



270-16772D (R)

1 Ton Bearing Races
Drilled Coarse Wheel Studs

270-6513C (R)

Coarse Wheel Studs

270-6513D (R)

Drilled Coarse Wheel Studs



270-6735BLS (F)

Long Coarse Studs



270-6735BC (F)

Coarse Wheel Studs

270-6735BD (F)

Drilled Coarse Wheel Studs



270-6735C (F)

Coarse Wheel Studs

270-6735D (F)

Drilled Coarse Wheel Studs



270-6735LS (F)

Long Coarse Studs

*For technical
questions
and more
information,
contact:*

Jim "Spike" Logue
(805) 384-4191
jlogue@wilwood.com

* (R) REAR / (F) FRONT AXLE

LUG-DRIVE DYNAMIC FLOATING ROTOR MOUNT

COMPONENTS



270-12111C (R)
Coarse Wheel Studs

270-12111D (R)
Drilled Coarse Wheel Studs



270-12127C (F)
Coarse Wheel Studs

270-12127D (F)
Drilled Coarse Wheel Studs



270-17461C (R)
Coarse Wheel Studs



270-17462C (F)
Coarse Wheel Studs



300-16922/ 300-16921
Dynamic Lug Mount Rotor
Adapter for for Starlite 55XD
Wide 5 Racing Hubs



300-12561
Dynamic Lug Rotor Mounting
and Snap Ring Kit

ACCESSORIES



270-13213



270-6733



270-16183



270-9498



270-6913



270-2189C

270-13213	Starlite 55 5-bolt Drive Flange with Oil Seal <i>(not for 1-ton rears)</i>	Rear
270-6733	Starlite 55 5-bolt Drive Flange	Rear
270-16183	Starlite 55 5-bolt Camber Drive Flange 2-Deg	Rear
270-9498	Starlite 55 5-bolt Dust Cap	Front
270-6913	Starlite 55 Press-in Snap Cap	Front
270-2189C	Wide 5 - 2" Wheel Spacer	Both

PEDALS

TRU-BAR



340-16380 6.25-7:1
Swing Mount **TRU-BAR** Brake
Pedal-**ADJUSTABLE RATIO**



340-15079 7:1
Swing Mount **TRU-BAR**
Brake Pedal



340-15073 5:1
340-15074 6.25:1
340-15075 6.25:1/5:1
Reverse Swing Mount **TRU-BAR**
Brake and Clutch Pedal



340-16386 5.5-6.25:1
Reverse Swing Mount
TRU-BAR Brake and Clutch
Pedal-**ADJUSTABLE RATIO**



340-15076 5:1
340-15077 6.25:1
Reverse Swing Mount
TRU-BAR Brake Pedal



340-16388 5.5-6.25:1
Reverse Swing Mount
TRU-BAR Brake Pedal-
ADJUSTABLE RATIO



340-15072 6.25:1
Swing Mount **TRU-BAR** Brake
and Clutch Pedal

VISIT OUR
RACING WEBSITE
WILWOODRACING.COM

PEDAL ACCESSORIES

TRU-BAR



340-14922 7:1
Swing Forward Mount

340-15151 5:1
Swing Reverse Mount

340-15152 6.25:1
Swing Reverse Mount

PEDALS

TRADITIONAL



340-13833 6:1
Floor Mount Clutch/Brake
Pedal



340-12509 6.25:1
340-13837 5.1:1
Reverse Swing Mount Brake
and Clutch Pedal



340-13574 6:1
Reverse Swing Mount
Clutch/Brake Pedal



340-11295 6.25:1
Swing Mount Brake and
Clutch Pedal



340-11299 6.25:1
340-13835 5.1:1
340-13836 6.25:1/5.1:1
Reverse Swing Mount Brake
and Clutch Pedal



340-13834 7:1
Swing Mount
Clutch/Brake Pedal



340-13832 7:1
Swing Mount Brake Pedal

TRADITIONAL PEDAL
REPLACEMENT KIT AVAILABLE

PEDAL ACCESSORIES



340-4745
Balance Bar Replacement



330-14505
Pedal Pad Kit



340-4990
Remote Bias Adjuster

MASTER CYLINDERS



Compact Remote Flange Mount Master Cylinder with Lightweight Reservoir Kit

- 261-16838-.75** 3/4"
- 261-17277-.81** 13/16"
- 261-16839-.88** 7/8"
- 261-17278-.94** 15/16"
- 261-16840-1.00** 1.00"
- 261-16841-1.12** 1-1/8"



Compact Remote Flange Mount Master Cylinder with Plastic Reservoir

- 260-10371** 5/8"
- 260-10372** 3/4"
- 260-10373** 13/16"
- 260-10374** 7/8"
- 260-14784** 15/16"
- 260-10375** 1.00"
- 260-10376** 1-1/8"



High Volume Master Cylinder

- 260-6764** 3/4"
- 260-6765** 7/8"
- 260-6766** 1.00"



Lightweight Reservoir Kit

- 260-16391** Direct Mount
- 260-16392** Remote Mount
- 330-16239** Cap Only



Billet Res. Bracket

- 250-16872** Single
- 250-16393** Dual
- 250-16874** Triple



Compact Remote Combination MC Rebuild Kit

- 260-10513** 5/8"
- 260-10514** 3/4"
- 260-10515** 13/16"
- 260-10516** 7/8"
- 260-14920** 15/16"
- 260-10517** 1.00"
- 260-10518** 1-1/8"



High Volume Master Cylinder Rebuild Kit

- 260-6898** 3/4"
- 260-6899** 7/8"
- 260-6900** 1.00"



260-15098 3/4"
GS Compact Integral MC

Can't find what you're looking for?

For more information and technical questions, contact:

JIM "SPIKE" LOGUE - (805) 384-4191 - jlogue@wilwood.com

BRAKE PADS



No-Bleed Quick Disconnect Fitting

Dry Break Quick Connect/
Disconnect -3 AN Fittings

260-16771 Kit
260-16770 Female
260-16769 Male



260-8419
Knob Proportioning Valve



260-8420
Lever Proportioning Valve



260-9921
Shutoff Valve



FOR MORE BRAKE PAD
INFORMATION, VISIT
WWW.WILWOODRACING.COM



Brake Pressure
Gauge

260-0966

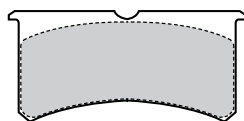

Pad Plate No. 7420

150-45-7420K BP-45
150-40-7420K BP-40
150-35-7420K BP-35
150-30-7420K BP-30
150-28-7420K BP-28
150-20-7420K BP-20

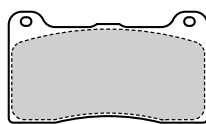

Pad Plate No. 7816

150-45-7816K BP-45
150-40-7816K BP-40
150-35-7816K BP-35
150-30-7816K BP-30
150-28-7816K BP-28
150-20-7816K BP-20



Brake Fluids and
Brake Bleed Bottle

290-16353 XR Race-Only
290-6209 EXP 600 Plus
290-0632 HI-TEMP 570
260-16018 Bleed Bottle

DISCLAIMER: Wilwood engineers brake kits and components for a wide variety of racing and high performance driving applications. It is the responsibility of the end user to choose the parts that are best suited for the braking demands encountered by his or her vehicle. Vehicle speed and weight, along with environmental conditions should always be taken into account when selecting and installing the kit or component that's right for you.

NOTES



P/N: CAT-DLM | Rev. 10/30/2024



| BRAKE KITS | CALIPERS | ROTORS | MASTER CYLINDERS | PEDALS | PRESSURE VALVES | HATS | BRAKE FLUID |
| BRAKE PADS | HUBS | PROSPINDLES | BRAKE LINES | FLEXLINES | PARKING BRAKES | HARDWARE |

SCAN & EXPLORE



RACING
wilwood
ESTABLISHED 1977

805.388.1188 | wilwoodracing.com |     