

### DIRT SPRINT CAR **GP200 CALIPER** **10.50"** REAR OUTBOARD BRAKE KIT

Wilwood has designed a powerful, lightweight rear outboard option to match the ever-evolving brake requirements of chassis design, tires, and driver needs in Sprint Car Racing. All components are race-proven and tested across the country.

Using a dynamically mounted super alloy rotor, a **Type III Hard Anodized** rotor plate, and Wilwood's latest FEA technology, racers and teams can be confident in the reliability and endurance of this specialty brake kit.

#### **CALIPER: GP200**

- Forged aluminum that weighs in at less than one pound
- Universal mounting options for front or rear bearing carrier location
- Low fluid displacement, translating to better pedal feel with less travel
- Type III Hard Anodized shell inside and out adds protection for longer life

#### **ROTOR: SA SCALLOPED**

- Super Alloy steel scalloped and drilled 10.50" x 0.19" rotor
- Splined aluminum Type III Hard Anodize rotor adapter plate is dynamically mounted using the included T-nut hardware

#### **BRAKE PADS: PURPLE**

- Composite metallic **Purple** compound for high temperature, provides long life, and has great pedal feel

#### **INSTALLATION PARTS:**

- All premium-grade hardware included

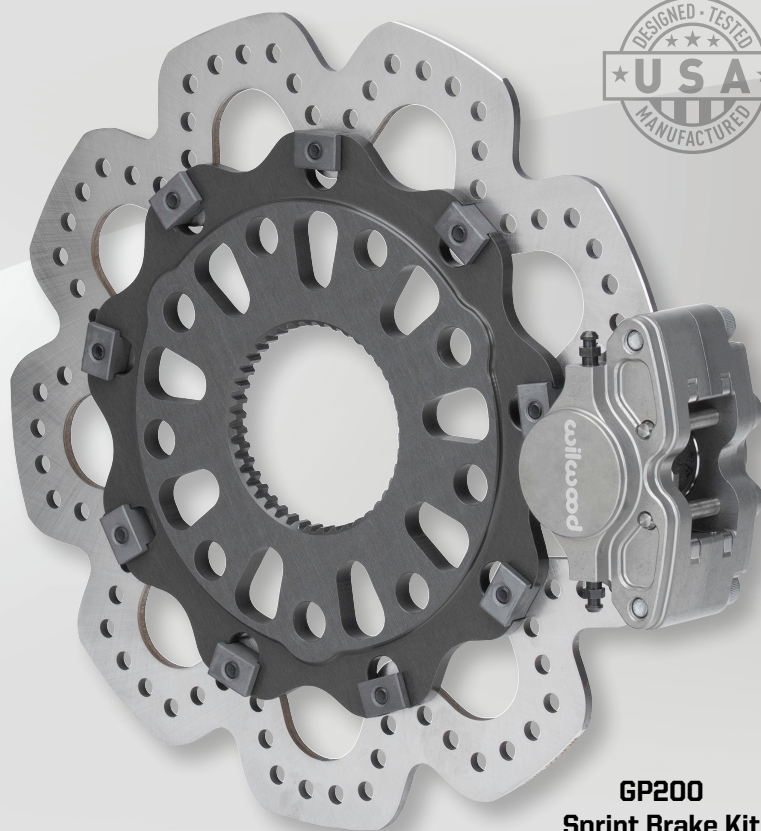

**GP200**  
**Sprint Brake Kit**  
**P/N: 140-18215**

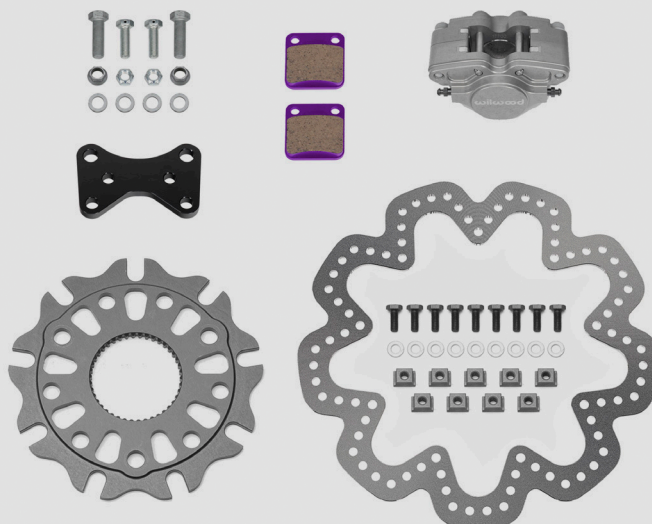



### TYPICAL INSTALLATION CONFIGURATION

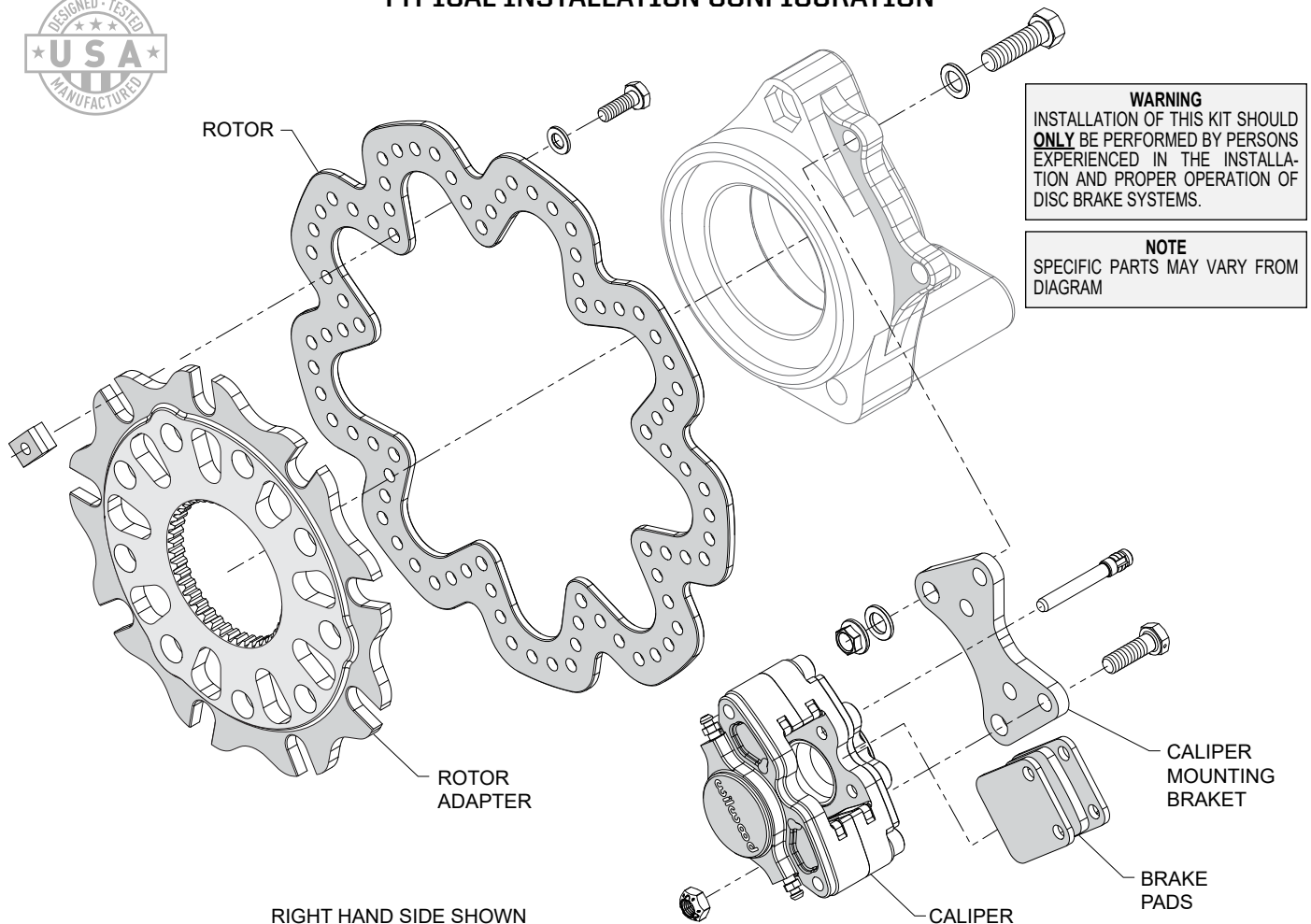

### ORDERING INFORMATION: GP200 CALIPER TYPE 4908 PAD

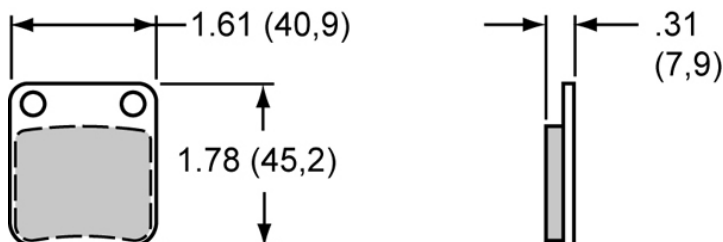

PART NUMBER	COMPOUND
<a href="#">150-28-4908K</a>	BP-28
<a href="#">150-12270</a>	Purple (included)

ORDERING INFO: PH: 805.388.1188 • FAX: 805.388.4938 • [wilwood.com](http://wilwood.com) • [info@wilwood.com](mailto:info@wilwood.com)

PART NUMBER	DESCRIPTION	CALIPER TYPE	CALIPER FINISH	ROTOR TYPE	ROTOR SIZE
<a href="#">140-18215</a>	GP200A, Sprint Outboard Rear Brake Kit	GP200, 2 Piston	Type III Hard Anodize	Scalloped	10.50" x 0.16"