



# FORD F-SERIES TRUCKS • FRONT/REAR TACTICAL XTREME TX6R BIG BRAKE KITS

*Tactical Xtreme TX6R radial mount six piston caliper kits are engineered for high GVWR Ford F-Series Trucks providing the ultimate in high strength braking for all types of highway and off-road extreme duty applications.*



## Kit Features



- Forged aluminum calipers with stainless steel pistons and high-temp internal bore seals
- Big diameter 14.25" - 16.00" **Spec 37** alloy directional vane rotors from 1.25" to 1.50" <sup>(1)</sup>
- BP-20 metallic - composite compound *Smart Pads*
- Fully compatible with the OE master cylinder output and electronic control systems
- Rear kits retains full use of factory parking brake
- Gloss black finish on base models with options for red powder coat or clear anodize
- DOT approved stainless steel braided flexline kits are required for installation and must be ordered separately by specific vehicle make, model and year
- Easy bolt-on installation with premium grade hardware and detailed instruction guide

(1) Check [www.wilwood.com](http://www.wilwood.com) for complete year/make/model application data and specific wheel clearance requirements

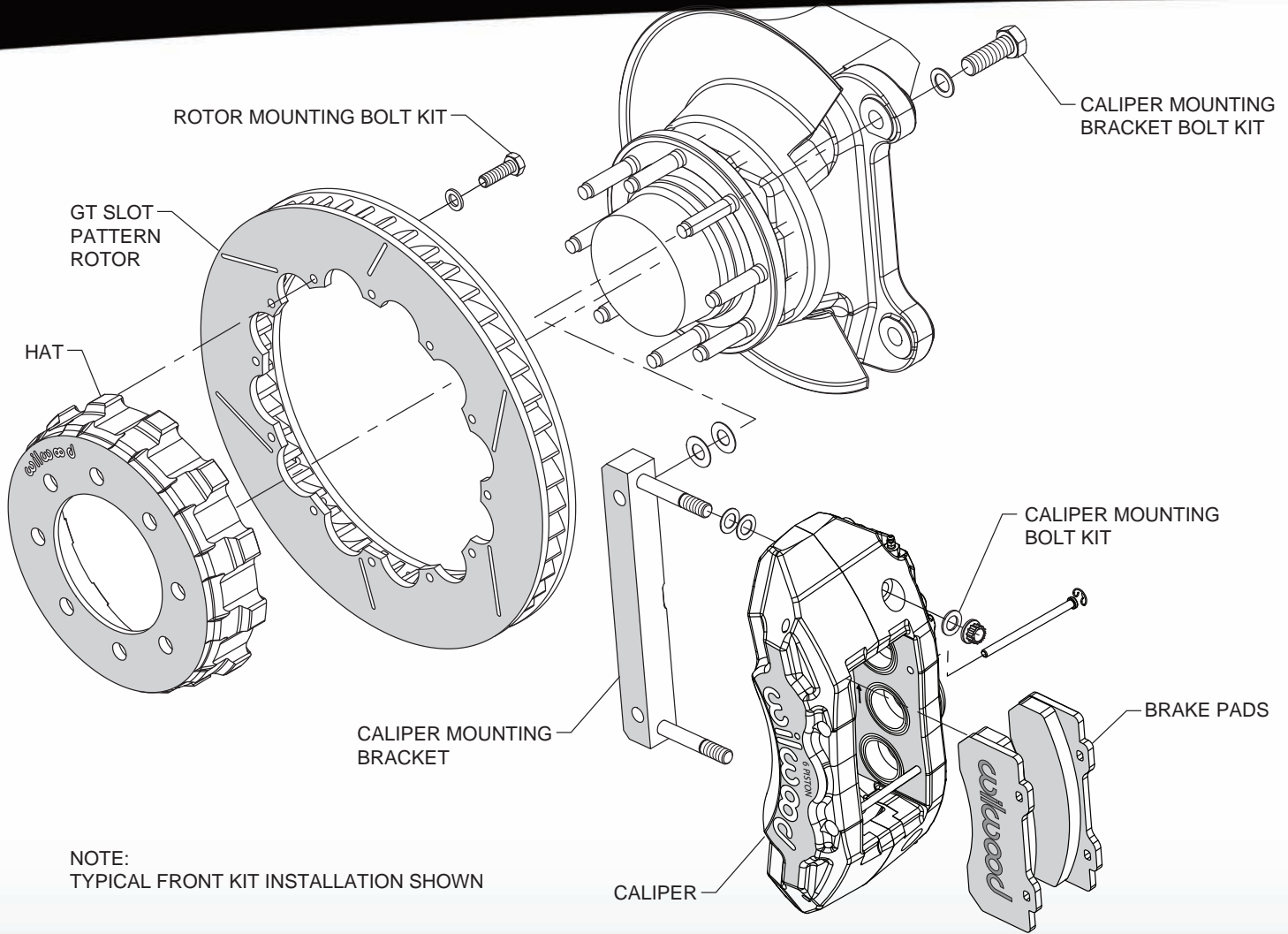

NOTE:  
TYPICAL FRONT KIT INSTALLATION SHOWN

**PLEASE CHECK:** WILWOOD ALWAYS RECOMMENDS CHECKING [www.wilwood.com](http://www.wilwood.com) FOR COMPLETE YEAR/MAKE/MODEL APPLICATION DATA AND SPECIFIC WHEEL CLEARANCE REQUIREMENTS.

## ORDERING INFORMATION: Front and Rear Brake Kits for Ford F-Series Trucks

PART NUMBER	DESCRIPTION	CALIPER FINISH
<a href="#">140-13865-C</a>	Front 2010-2016 Ford F-150, 1/2 Ton, 2WD, TX6R Caliper, 15.50" <b>Spec37</b> GT Series Rotor	Clear Anodized
<a href="#">140-13865</a>	Front 2010-2016 Ford F-150, 1/2 Ton, 2WD, TX6R Caliper, 15.50" <b>Spec37</b> GT Series Rotor	Black Powder Coat
<a href="#">140-13865-R</a>	Front 2010-2016 Ford F-150, 1/2 Ton, 2WD, TX6R Caliper, 15.50" <b>Spec37</b> GT Series Rotor	Red Powder Coat
<a href="#">140-13866-C</a>	Rear 2012-2016 Ford F-150, 1/2 Ton, 2WD, TX6R Caliper, 14.25" <b>Spec37</b> GT Series Rotor	Clear Anodized
<a href="#">140-13866</a>	Rear 2012-2016 Ford F-150, 1/2 Ton, 2WD, TX6R Caliper, 14.25" <b>Spec37</b> GT Series Rotor	Black Powder Coat
<a href="#">140-13866-R</a>	Rear 2012-2016 Ford F-150, 1/2 Ton, 2WD, TX6R Caliper, 14.25" <b>Spec37</b> GT Series Rotor	Red Powder Coat
<a href="#">140-13867-C</a>	Front 2005-2012 Ford F-250, 3/4 Ton, 4WD, TX6R Caliper, 16.00" <b>Spec37</b> GT Series Rotor	Clear Anodized
<a href="#">140-13867</a>	Front 2005-2012 Ford F-250, 3/4 Ton, 4WD, TX6R Caliper, 16.00" <b>Spec37</b> GT Series Rotor	Black Powder Coat
<a href="#">140-13867-R</a>	Front 2005-2012 Ford F-250, 3/4 Ton, 4WD, TX6R Caliper, 16.00" <b>Spec37</b> GT Series Rotor	Red Powder Coat
<a href="#">140-13868-C</a>	Rear 2005-2012 Ford F-250, 3/4 Ton, 4WD, TX6R Caliper, 15.50" <b>Spec37</b> GT Series Rotor	Clear Anodized
<a href="#">140-13868</a>	Rear 2005-2012 Ford F-250, 3/4 Ton, 4WD, TX6R Caliper, 15.50" <b>Spec37</b> GT Series Rotor	Black Powder Coat
<a href="#">140-13868-R</a>	Rear 2005-2012 Ford F-250, 3/4 Ton, 4WD, TX6R Caliper, 15.50" <b>Spec37</b> GT Series Rotor	Red Powder Coat
<a href="#">140-15286-C</a>	Front 2004-2008 Ford F-150, 1/2 Ton, 4WD, TX6R Caliper, 15.50" <b>Spec37</b> GT Series Rotor	Clear Anodized
<a href="#">140-15286</a>	Front 2004-2008 Ford F-150, 1/2 Ton, 4WD, TX6R Caliper, 15.50" <b>Spec37</b> GT Series Rotor	Black Powder Coat
<a href="#">140-15286-R</a>	Front 2004-2008 Ford F-150, 1/2 Ton, 4WD, TX6R Caliper, 15.50" <b>Spec37</b> GT Series Rotor	Red Powder Coat