

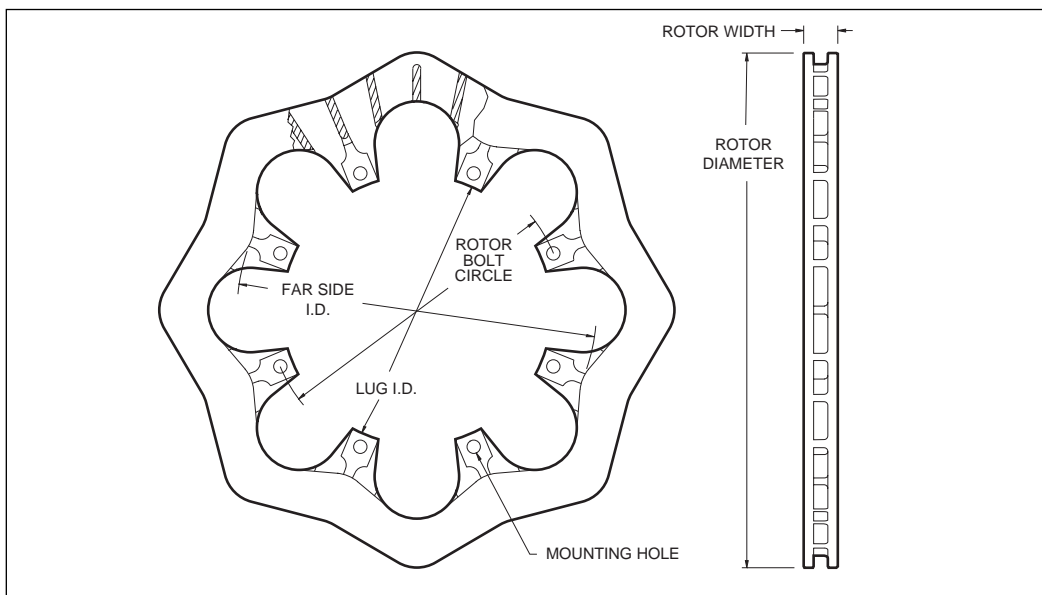

# Wilwood's New ULS-32 Scalloped Rotors

## Ultra-Light Scalloped Series .81" Thick Rotors

- Premium grade long grain carbon iron rotors provide long wear with high thermal stability and resistance to distortion.
- 32 vane construction provides high heat absorption and dissipation qualities
- Increased cooling capacity over machined plate rotors
- Lower weight and higher durability over drilled rotors
- Fits all standard 8 on 7.00" pattern hubs, open wheel axle mounts, and hats
- Mounting characteristics shown below

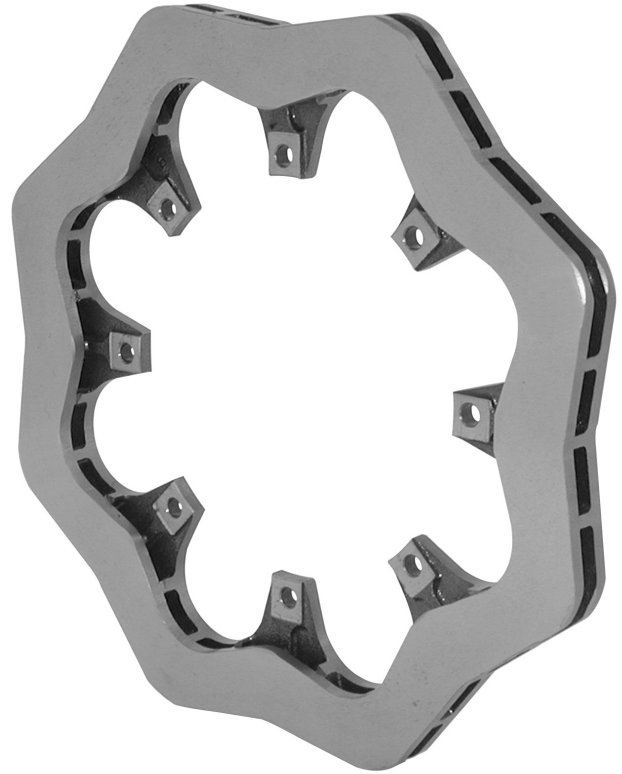

### ORDERING INFORMATION:

<u>Rotor P/N</u>	<u>Size</u>	<u>Bolt Circle</u>	<u>Hole Type</u>	<u>Weight - Lbs</u>
160-8135	11.75 x .81"	8 x 7.00"	.325"	5.4
160-8136	12.19 x .81"	8 x 7.00"	.325"	5.9