

DISC BRAKES
wilwood

PROSPINDLE / MUSTANG II

**FDLI / DP6 / 5 x 5.00" HUB
FRONT BRAKE KITS**

***FRONT BRAKE KITS** for the Wilwood Mustang II style ProSpindle and conventional OE Pinto / Mustang II spindles combine cutting-edge technology and high-tech styling to deliver big brake power for all types of custom street, strip and show-quality hot rods.*



KIT FEATURES



- Newly-designed billet hub made specifically for 5 x 5.00" stud pattern wheels
- Dynalite four piston or DynaPro 6 six piston forged aluminum calipers with stainless steel pistons
- Calipers are available in black and red powder coat or 22 additional color options
- Choice of ULHP smooth face or SRP drilled and slotted 12.19" x .81" thick vented iron rotors
- BP-10 high performance metallic - composite compound *SmartPads*
- Compatible with manual or power brakes with the appropriately-sized master cylinder
- Complete kits include bearings, seals, caliper brackets, and all necessary hardware to mount the brakes to the spindles
- Installation requires new flexlines that must be ordered separately
- Requires 15" or larger wheels. Wheel clearance diagrams are available at www.wilwood.com

Note: Check www.wilwood.com for complete year/make/model application data and specific wheel clearance requirements.

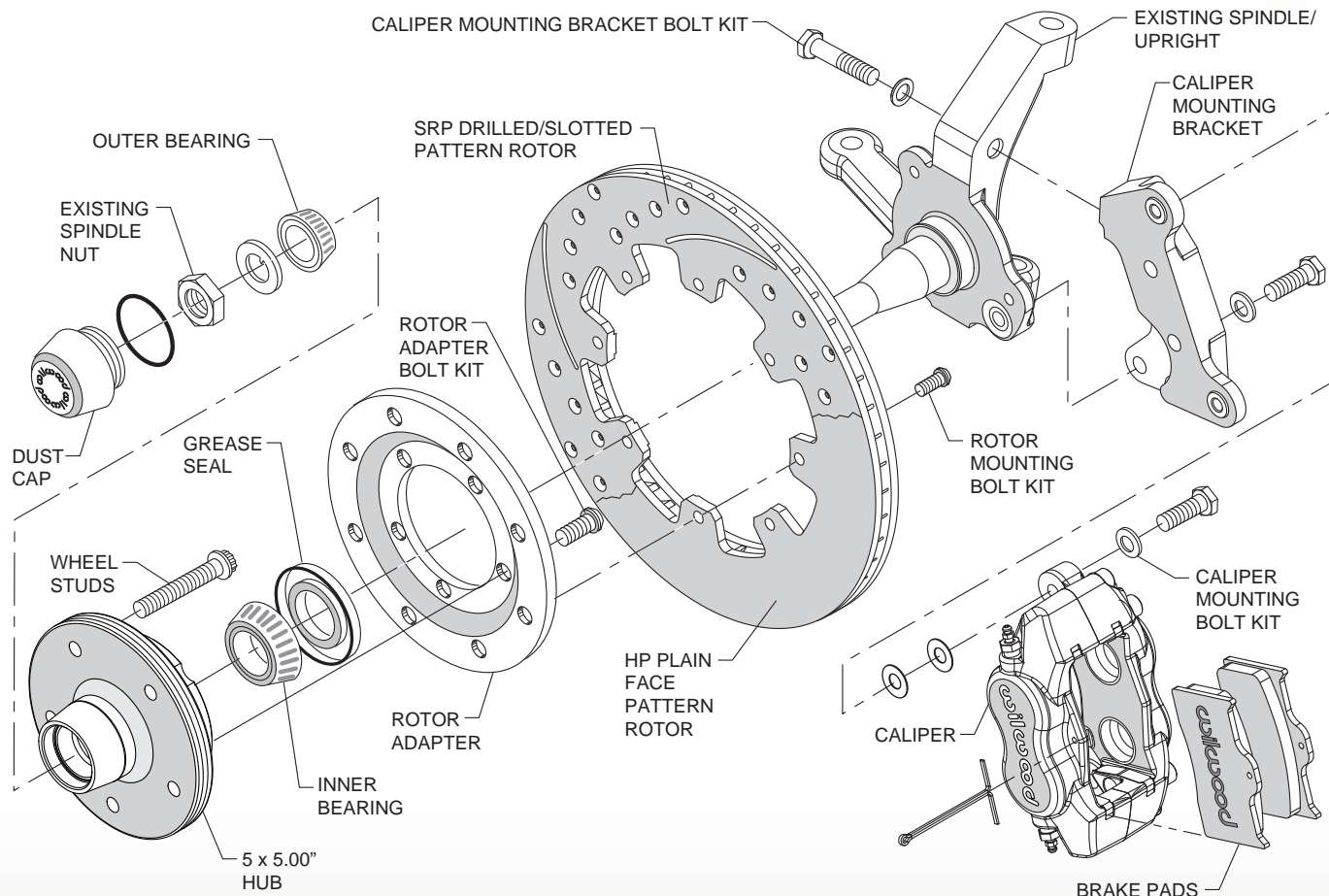

Figure 1. Typical Installation Diagram, Dynalite Kit Shown

PLEASE CHECK: WILWOOD ALWAYS RECOMMENDS CHECKING www.wilwood.com FOR COMPLETE YEAR/MAKE/MODEL APPLICATION DATA AND SPECIFIC WHEEL CLEARANCE REQUIREMENTS.

ORDERING INFORMATION: Wilwood ProSpindle and Mustang II 5 x 5.00" Hub Front Brake Kits

PART NUMBER	DESCRIPTION	CALIPER FINISH
140-14530	Mustang II, Dynalite Four Piston Calipers, 12.19" Diameter ULHP Smooth Face Rotors	Black Powder Coat
140-14530-D	Mustang II, Dynalite Four Piston Calipers, 12.19" Diameter SRP Drilled and Slotted Rotors	Black Powder Coat
140-14530-R	Mustang II, Dynalite Four Piston Calipers, 12.19" Diameter ULHP Smooth Face Rotors	Red Powder Coat
140-14530-DR	Mustang II, Dynalite Four Piston Calipers, 12.19" Diameter SRP Drilled and Slotted Rotors	Red Powder Coat
140-14531	Mustang II, DynaPro 6 Six Piston Calipers, 12.19" Diameter ULHP Smooth Face Rotors	Black Powder Coat
140-14531-D	Mustang II, DynaPro 6 Six Piston Calipers, 12.19" Diameter SRP Drilled and Slotted Rotors	Black Powder Coat
140-14531-R	Mustang II, DynaPro 6 Six Piston Calipers, 12.19" Diameter ULHP Smooth Face Rotors	Red Powder Coat
140-14531-DR	Mustang II, DynaPro 6 Six Piston Calipers, 12.19" Diameter SRP Drilled and Slotted Rotors	Red Powder Coat
140-14532	ProSpindle, Dynalite Four Piston Calipers, 12.19" Diameter ULHP Smooth Face Rotors	Black Powder Coat
140-14532-D	ProSpindle, Dynalite Four Piston Calipers, 12.19" Diameter SRP Drilled and Slotted Rotors	Black Powder Coat
140-14532-R	ProSpindle, Dynalite Four Piston Calipers, 12.19" Diameter ULHP Smooth Face Rotors	Red Powder Coat
140-14532-DR	ProSpindle, Dynalite Four Piston Calipers, 12.19" Diameter SRP Drilled and Slotted Rotors	Red Powder Coat
140-14533	ProSpindle, DynaPro 6 Six Piston Calipers, 12.19" Diameter ULHP Smooth Face Rotors	Black Powder Coat
140-14533-D	ProSpindle, DynaPro 6 Six Piston Calipers, 12.19" Diameter SRP Drilled and Slotted Rotors	Black Powder Coat
140-14533-R	ProSpindle, DynaPro 6 Six Piston Calipers, 12.19" Diameter ULHP Smooth Face Rotors	Red Powder Coat
140-14533-DR	ProSpindle, DynaPro 6 Six Piston Calipers, 12.19" Diameter SRP Drilled and Slotted Rotors	Red Powder Coat