

All new (not rebuilt, cast iron calipers, purpose built for racing. Wilwood's GM Metric Calipers are bolt-on replacements for 1978 and later GM Metric calipers widely used in "spec" racing categories.

FEATURE

- New casting purpose-built for racing (not a remanufactured part)
- Stainless steel piston and high temperature bore seals
- Equipped with high-temp square section seals for ultimate pedal-feel and resistance to excessive piston knock-back
- Dual symmetrical bleeders eliminate the need for carrying multiple spares as calipers may be right or left mounted



HARDENED SLIDE PINS

- High-strength alloy steel
- Black oxide coat finish
- Each caliper requires two slide pins
- Four-pack sold separately (P/N: 230-0619)



CALIPER FITTING
Sold separately
P/N: 220-17471



ORDERING INFO: PH: 805.388.1188 • FAX: 805.388.4938 • wilwood.com • info@wilwood.com

PART NUMBER	DESCRIPTION	PISTON BORE SIZE	FINISH
120-9333	GM Metric Cast Iron D-154 Caliper	2.00" (50.8 mm)	Black E-Coat
120-16101	GM Metric Cast Iron D-154 Caliper IMCA LEGAL	2.50" (63.5 mm)	Black E-Coat
120-8924	GM Metric Cast Iron D-154 Caliper	2.75" (69.9 mm)	Black E-Coat
230-0619	Bolt Kit - Caliper Slide Pin 4-pack		Black Oxide Coated
220-17471	Caliper Inlet Fitting -3 TO 10mm-1.5 with a crush washer		

GM Metric Iron Caliper, Dimensional Characteristics

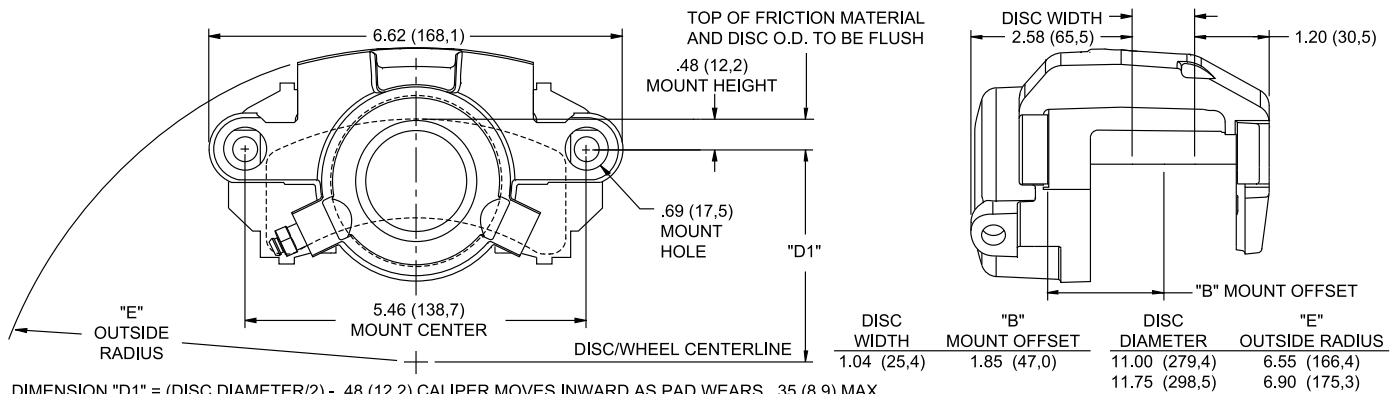

GM Metric Iron Caliper, Type D154 Brake Pad Dimensions and Ordering Information

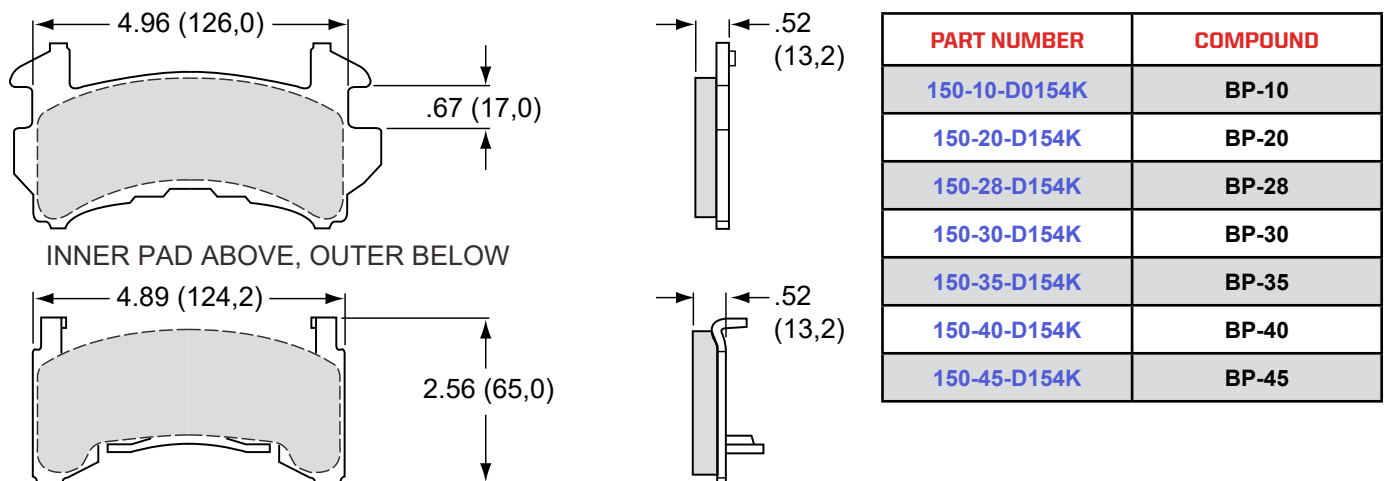

GM Metric Iron Caliper, User Serviceable Components and Ordering Information

CALIPER PART NUMBER	PISTON	O-RING	BLEED SCREW
120-9333	200-9342	130-0777	220-8932
120-16101	200-11793	130-12084	220-8932
120-8924	200-6633	130-4955	220-8932