



BILLET DYNAPRO CALIPER

Caliper Highlights:

The **DynaPro** four-piston radial mount caliper combines pure race technology with a new generation of Wilwood performance enhancements. Its sleek profile, superior strength, and durability in adverse conditions are easily adapted to a broad range of sports, rally and off-road driving applications.

The strength of the **DynaPro** is a combination of process and design. The process of stress-flow forging re-aligns the metal's grain structure within the contour of the caliper body. This eliminates the stresses and interruptions to the internal grain structure that occur when machining a straight block billet. The FEA generated radial transition design eliminates steps and shoulders in the area between the piston housing body and the caliper bridges. Incorporating a radius in this critical area substantially increases resistance to deflection and caliper separation under load. Structural deflection and volume displacement tests have proven the efficiency of this innovative design. Without even considering the overall greater strength and reliability of the billet forging, the reduction in overall deflection and fluid volume displacement translate to increased clamping efficiency with less pedal travel. The bottom line is a firm pedal with outstanding stopping power.



The superior strength of this innovative design is combined with a new generation of Wilwood performance features. The **DynaPro** uses a new 7816 type brake pad that is supported from the top by Quick-Clip pad retainers. This feature eliminates the need for a pad support step in the bottom of the caliper and adds additional clearance for mounting closer to the hub on small wheel and small rotor applications. The pad radius matches to rotor diameters between 9.45" (240,0 mm) and 12.19" (309,6 mm), and the caliper fits easily inside many 13.00" wheel applications. The Quick-Clips also accommodate easy pad access without caliper removal. PolyMatrix pad compounds are available to cover the full range of sport and competition applications. Other new Wilwood features include coated aluminum pistons fitted with high temperature rubber boots that seal out dirt, moisture, and debris from the piston bores in less than friendly environments.

Every caliper is equipped with Wilwood's SRS stainless steel bridge plates. The SRS plates eliminate the bridge wear caused by pad gouging and extend the service life of the caliper body. The spring-loading action of the SRS plates also eliminates pad rattle and dampens the vibration harmonics that contribute to squeal under braking. Internal fluid passages eliminate the need for external tubes. Four corner bleed screws assure simple and effective air evacuation from the system and allow one caliper to be mounted in any front, rear, right or left position.

NOTE: For sustained high temperature operation in severe duty competition, the **DynaPro** can be fitted with one piece stainless steel or Wilwood's exclusive **Thermlock**® piston technology without the dust boots. Contact Wilwood or your dealer with requirements.

ORDERING INFORMATION⁽¹⁾:

BORE SIZE		DISC WIDTH		PART NUMBER
1.75"	44,5 mm	1.00"	25,4 mm	120-7381
1.75"	44,5 mm	.81"	20,6 mm	120-7380
1.75"	44,5 mm	.38" - .50"	9,7 - 12,7 mm	120-7726
1.75"	44,5 mm	1.00"	25,4 mm	120-8545 ⁽²⁾
1.75"	44,5 mm	.81"	20,6 mm	120-8544 ⁽²⁾
1.75"	44,5 mm	.81"	20,6 mm	120-8544-SI ⁽²⁾
1.75"	44,5 mm	.38" - .50"	9,7 - 12,7 mm	120-8543 ⁽²⁾
1.75"	44,5 mm	.38" - .50"	9,7 - 12,7 mm	120-8543-SI ⁽²⁾
1.62"	41,1 mm	1.00"	25,4 mm	120-7379 ⁽³⁾
1.62"	41,1 mm	.81"	20,6 mm	120-7378 ⁽³⁾
1.62"	41,1 mm	.38" - .50"	9,7 - 12,7 mm	120-7725
1.62"	41,1 mm	1.00"	25,4 mm	120-8542 ⁽²⁾
1.62"	41,1 mm	.81"	20,6 mm	120-8541 ⁽²⁾
1.62"	41,1 mm	.38" - .50"	9,7 - 12,7 mm	120-8540 ⁽²⁾
1.50"	38,1 mm	1.00"	25,4 mm	120-7328
1.50"	38,1 mm	.81"	20,6 mm	120-7327 ⁽³⁾
1.50"	38,1 mm	.38" - .50"	9,7 - 12,7 mm	120-7722
1.38"	35,1 mm	1.00"	25,4 mm	120-7377
1.38"	35,1 mm	.81"	20,6 mm	120-7376 ⁽³⁾
1.38"	35,1 mm	.38" - .50"	9,7 - 12,7 mm	120-7724
1.38"	35,1 mm	1.00"	25,4 mm	120-8539 ⁽²⁾
1.38"	35,1 mm	.81"	20,6 mm	120-8538 ⁽²⁾
1.38"	35,1 mm	.38" - .50"	9,7 - 12,7 mm	120-8537 ⁽²⁾
1.25"	31,8 mm	1.00"	25,4 mm	120-7375
1.25"	31,8 mm	.81"	20,6 mm	120-7374 ⁽³⁾
1.25"	31,8 mm	.38" - .50"	9,7 - 12,7 mm	120-7723
1.25"	31,8 mm	1.00"	25,4 mm	120-8536 ⁽²⁾
1.25"	31,8 mm	.81"	20,6 mm	120-8535 ⁽²⁾
1.25"	31,8 mm	.38" - .50"	9,7 - 12,7 mm	120-8534 ⁽²⁾

NOTES: (1) CALIPER MOUNTING BRACKET KIT 5.98" (152,0) RADIAL TO 3.50" (88,9) LUG MOUNT - P/N: 250-6309
 (2) THESE CALIPERS HAVE STAINLESS STEEL PISTONS WITHOUT DUST BOOTS
 (3) AVAILABLE RED, ADD "RD" TO END OF PART NUMBER WHEN ORDERING

4700 Calle Bolero • Camarillo, CA 93012 • www.wilwood.com • Sales: 805 / 388-1188 • Fax: 805 / 388-4938

DYNAPRO CALIPER, MOUNTING DIMENSIONS:

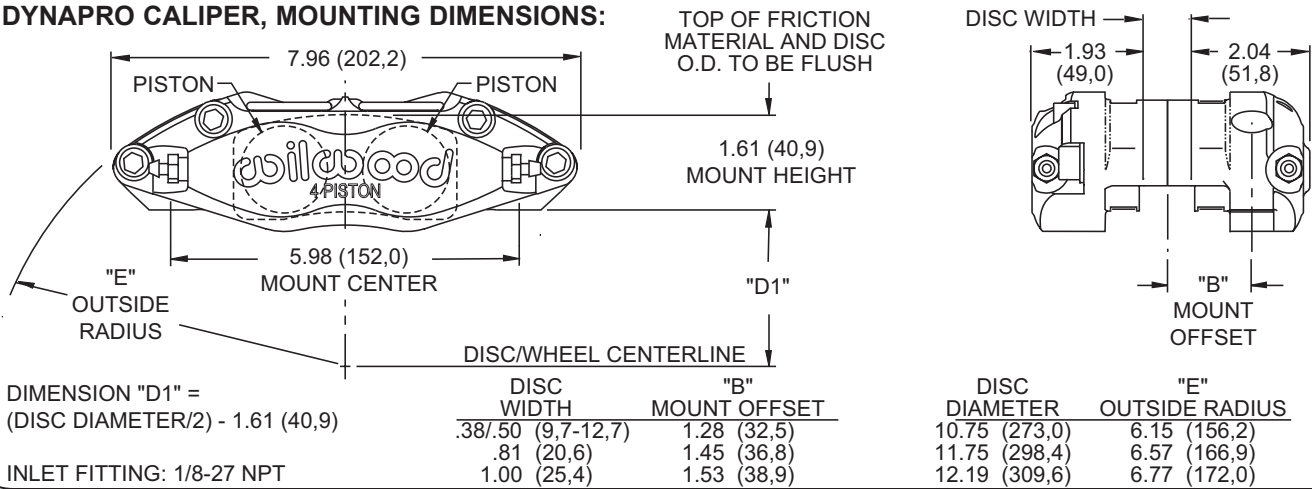

TYPICAL DYNAPRO RADIAL MOUNTING BRACKET, MOUNTING DIMENSIONS, PART NUMBER 250-6309:

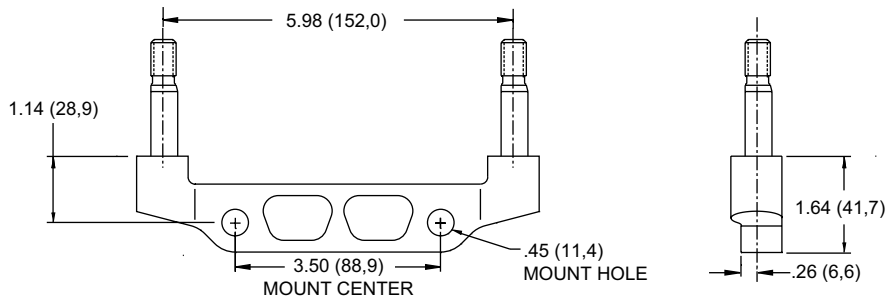

NOTE:
BRACKET KIT INCLUDES
STUDS, LOCKNUTS,
WASHERS AND
ALIGNMENT SHIMS

DYNAPRO CALIPER, TYPE 7816 PAD DIMENSIONS AND ORDERING INFORMATION:

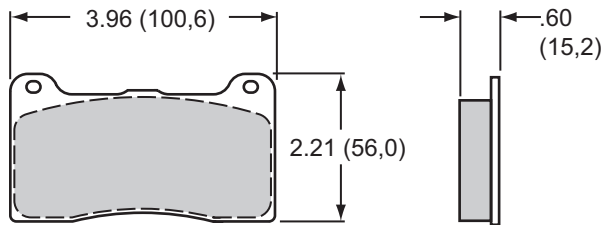

AXLE SET PART NO.	PAD TYPE/COMPOUND
15A - 7263K	7816 A PolyMatrix
15B - 7264K	7816 B PolyMatrix
15E - 7266K	7816 E PolyMatrix
15Q - 7268K	7816 Q PolyMatrix
150 - 8946K	7816 10 BP-10 Smart Pad
150 - 9419K	7816 20 BP-20 Smart Pad
150 - 9865K	7816 30 BP-30 Smart Pad

ORDERING INFORMATION, USER SERVICEABLE COMPONENTS:

CALIPER PART NO.	PISTON	SQ RING KIT (4 PK)	BLEED SCREW KIT (4 PK)	DUST BOOT (EA)	BODY SEAL (EA)	BRIDGE WEAR PLATE (EA)	PAR RETAINER CLIP (EA)
120-7327	200-7320 (1.50")	130-8372	220-6069	210-7210	210-2582	300-5876	300-7316
120-7328	200-7320 (1.50")	130-8372	220-6069	210-7210	210-2582	300-5876	300-7316
120-7374	200-7318 (1.25")	130-2479	220-6069	210-7210	210-2582	300-5876	300-7316
120-7375	200-7318 (1.25")	130-2479	220-6069	210-7210	210-2582	300-5876	300-7316
120-7376	200-7319 (1.38")	130-2658	220-6069	210-7210	210-2582	300-5876	300-7316
120-7377	200-7319 (1.38")	130-2658	220-6069	210-7210	210-2582	300-5876	300-7316
120-7378	200-7321 (1.62")	130-4346	220-6069	210-7210	210-2582	300-5876	300-7316
120-7379	200-7321 (1.62")	130-4346	220-6069	210-7210	210-2582	300-5876	300-7316
120-7380	200-7322 (1.75")	130-2655	220-6069	210-7210	210-2582	300-5876	300-7316
120-7381	200-7322 (1.75")	130-2655	220-6069	210-7210	210-2582	300-5876	300-7316
120-7722	200-7320 (1.50")	130-8372	220-6069	210-7210	210-2582	300-5876	300-7315
120-7723	200-7318 (1.25")	130-2479	220-6069	210-7210	210-2582	300-5876	300-7315
120-7724	200-7319 (1.38")	130-2658	220-6069	210-7210	210-2582	300-5876	300-7315
120-7725	200-7321 (1.62")	130-4346	220-6069	210-7210	210-2582	300-5876	300-7315
120-7726	200-7322 (1.75")	130-2655	220-6069	210-7210	210-2582	300-5876	300-7315
120-8534	200-7514 (1.25")	130-2479	220-6069	—	210-2582	300-5876	300-7316
120-8535	200-7514 (1.25")	130-2479	220-6069	—	210-2582	300-5876	300-7316
120-8536	200-7514 (1.25")	130-2479	220-6069	—	210-2582	300-5876	300-7316
120-8537	200-7516 (1.38")	130-2658	220-6069	—	210-2582	300-5876	300-7315
120-8538	200-7516 (1.38")	130-2658	220-6069	—	210-2582	300-5876	300-7316
120-8539	200-7516 (1.38")	130-2658	220-6069	—	210-2582	300-5876	300-7316
120-8540	200-7519 (1.62")	130-4346	220-6069	—	210-2582	300-5876	300-7315
120-8541	200-7519 (1.62")	130-4346	220-6069	—	210-2582	300-5876	300-7316
120-8542	200-7519 (1.62")	130-4346	220-6069	—	210-2582	300-5876	300-7316
120-8543	200-7531 (1.75")	130-2655	220-6069	—	210-2582	300-5876	300-7315
120-8544	200-7531 (1.75")	130-2655	220-6069	—	210-2582	300-5876	300-7316
120-8545	200-7531 (1.75")	130-2655	220-6069	—	210-2582	300-5876	300-7316