

REAR G-BODY DRUM-TO-DISC BRAKE KITS FOR 7.5" and 7.625" DIFFERENTIAL (2.62" AXLE OFFSET)

Upgrading the brakes on older GM G-Body platform vehicles with a 7-1/2" or 7-5/8" differential and 2.62" axle offset, is now easier with Wilwood-engineered kits, thus making them safer with improved stopping performance.

Wilwood brake kits provide you with more clamping force, thermal capacity, and improved pedal feel, along with stopping confidence in your daily driving and heavy-use applications more suited to the power produced in these cars.

These brake kits are engineered to bolt on after modification to the OE axle housing flange. Rear kits are compatible with Wilwood or OE front brakes. Kits include internal drum parking brake assemblies. Four kits available to fit most wheel sizes.

KITS FEATURE:

- Complete bolt-on installation (requires modifications to the OE axle housing flange) using precision-machined high-strength brackets
- Compatible with Wilwood or OE front kits and OE master cylinder
- Internal drum parking brakes retain OE feature (optional cable kit sold separately if needed, see next page)
- Stainless steel pistons are housed in Type-III hard anodized bores with high-temperature seals for durability
- Calipers offered in gloss red or black powder coat, and 24 optional color choices (additional charges apply)

DynaPro 11.00" Low-Profile Kit:

- Stress-flow forged caliper designed for maximum rigidity in a compact shape allows clearance in some 14" wheels
- OE-style one-piece 11.00" x 0.81" vented 32 vane iron alloy rotors in plain face or black E-coated SRP drilled & slotted

Dynalite 12.19" Kit:

- Motorsports-proven forged caliper provides big piston area in a small, lightweight body and fits most 15" and larger wheels
- OE-style one-piece 12.19" x 0.81" vented 32 vane iron alloy rotors in plain face or black E-coated SRP drilled & slotted

Superlite 12.88" & 14.00" Kits:

- Wilwood's venerable motorsports-proven rigid four piston calipers
- Two-piece aluminum hat/rotor in vented **Spec37** iron alloy, black E-coated in GTB slotted or SRP drilled & slotted
- Two-piece 12.88" x 1.10" with 48 curved vanes for most 17" wheels
- Two-piece 14.00" x 1.10" with 72 curved vanes for most 18" wheels

BRAKE PADS: BP-10

- BP-10 street performance pads provide smooth and consistent response with long wear (other compounds available)

INSTALLATION PARTS:

- Caliper brackets and premium-grade installation hardware included



FDP-LP
G-BODY
11.00"
REAR KITS
[P/N 140-17120](#)

FDLI
G-BODY
12.19"
REAR KITS
[P/N 140-17121](#)

FNSL4R
G-BODY
12.88"
REAR KITS
[P/N 140-17658](#)

FNSL4R
G-BODY
14.00"
REAR KITS
[P/N 140-17659](#)



REAR G-BODY DRUM-TO-DISC BRAKE KITS FOR 7.5" and 7.625" DIFFERENTIAL (2.62" AXLE OFFSET)

TYPICAL INSTALLATION CONFIGURATION GM G-BODY - REAR

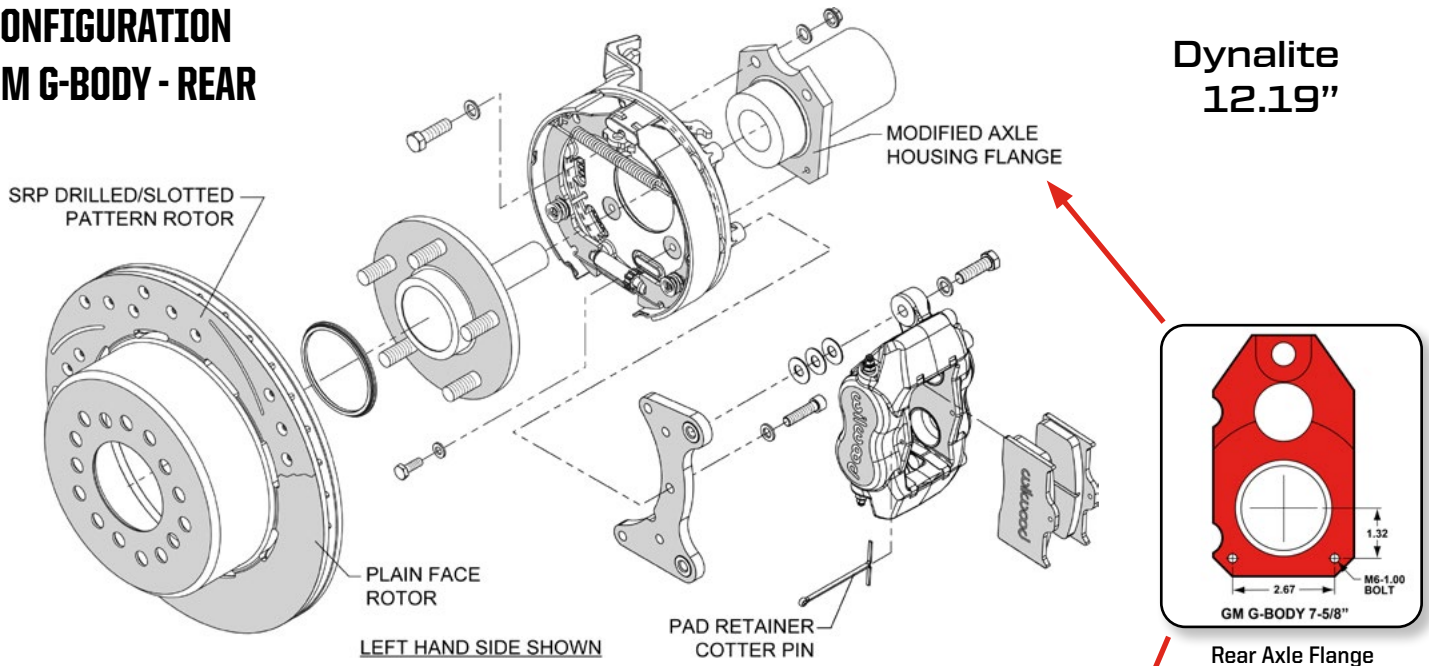

WARNING
INSTALLATION OF THIS KIT SHOULD ONLY BE PERFORMED BY PERSONS EXPERIENCED IN THE INSTALLATION AND PROPER OPERATION OF DISC BRAKE SYSTEMS.

NOTE
SPECIFIC PARTS MAY VARY FROM DIAGRAM

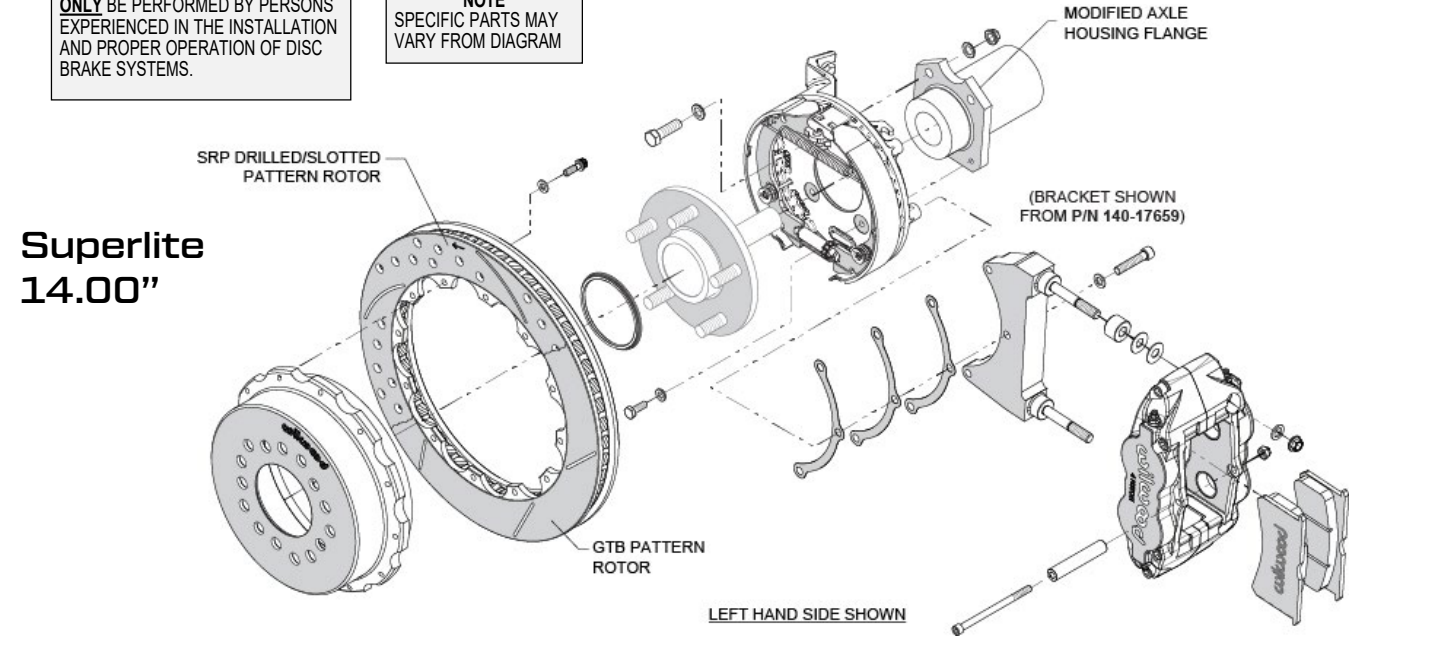

REAR G-BODY DRUM-TO-DISC BRAKE KITS FOR 7.5" and 7.625" DIFFERENTIAL (2.62" AXLE OFFSET)

BRAKE KITS ORDERING INFO: PH: 805.388.1188 • FAX: 805.388.4938 • wilwood.com • info@wilwood.com

PART NUMBER	DESCRIPTION	CALIPER TYPE	CALIPER FINISH	ROTOR SIZE	ROTOR TYPE
140-17120	Four Piston DynaPro Low-Profile Caliper, HP 32 Vane Vented Plain Face Rotor	DynaPro FDP-LP	Black Powder Coat	11.00" x 0.81"	Plain Face
140-17120-R	Four Piston DynaPro Low-Profile Caliper, HP 32 Vane Vented Plain Face Rotor	DynaPro FDP-LP	Red Powder Coat	11.00" x 0.81"	Plain Face
140-17120-D	Four Piston DynaPro Low-Profile Caliper, HP 32 Vane Vented Drilled & Slotted Rotor	DynaPro FDP-LP	Black Powder Coat	11.00" x 0.81"	SRP Drilled & Slotted
140-17120-DR	Four Piston DynaPro Low-Profile Caliper, HP 32 Vane Vented Drilled & Slotted Rotor	DynaPro FDP-LP	Red Powder Coat	11.00" x 0.81"	SRP Drilled & Slotted
140-17121	Four Piston Dyalite Caliper, HP 32 Vane Vented Plain Face Rotor	Dyalite FDLI	Black Powder Coat	12.19" x 0.81"	Plain Face
140-17121-R	Four Piston Dyalite Caliper, HP 32 Vane Vented Plain Face Rotor	Dyalite FDLI	Red Powder Coat	12.19" x 0.81"	Plain Face
140-17121-D	Four Piston Dyalite Caliper, HP 32 Vane Vented Drilled & Slotted Rotor	Dyalite FDLI	Black Powder Coat	12.19" x 0.81"	SRP Drilled & Slotted
140-17121-DR	Four Piston Dyalite Caliper, HP 32 Vane Vented Drilled & Slotted Rotor	Dyalite FDLI	Red Powder Coat	12.19" x 0.81"	SRP Drilled & Slotted
140-17658	Four Piston Superlite 4R Caliper, 48 Curved Vane Vented Spec37 GTB Slotted Rotor	Superlite FNLS4R	Black Powder Coat	12.88" x 1.10"	GTB Slotted
140-17658-R	Four Piston Superlite 4R Caliper, 48 Curved Vane Vented Spec37 GTB Slotted Rotor	Superlite FNLS4R	Red Powder Coat	12.88" x 1.10"	GTB Slotted
140-17658-D	Four Piston Superlite 4R Caliper, 48 Curved Vane Vented Spec37 SRP Drilled & Slotted Rotor	Superlite FNLS4R	Black Powder Coat	12.88" x 1.10"	SRP Drilled & Slotted
140-17658-DR	Four Piston Superlite 4R Caliper, 48 Curved Vane Vented Spec37 SRP Drilled & Slotted Rotor	Superlite FNLS4R	Red Powder Coat	12.88" x 1.10"	SRP Drilled & Slotted
140-17659	Four Piston Superlite 4R Caliper, 72 Curved Vane Vented Spec37 GTB Slotted Rotor	Superlite FNLS4R	Black Powder Coat	14.00" x 1.10"	GTB Slotted
140-17659-R	Four Piston Superlite 4R Caliper, 72 Curved Vane Vented Spec37 GTB Slotted Rotor	Superlite FNLS4R	Red Powder Coat	14.00" x 1.10"	GTB Slotted
140-17659-D	Four Piston Superlite 4R Caliper, 72 Curved Vane Vented Spec37 SRP Drilled & Slotted Rotor	Superlite FNLS4R	Black Powder Coat	14.00" x 1.10"	SRP Drilled & Slotted
140-17659-DR	Four Piston Superlite 4R Caliper, 72 Curved Vane Vented Spec37 SRP Drilled & Slotted Rotor	Superlite FNLS4R	Red Powder Coat	14.00" x 1.10"	SRP Drilled & Slotted
	ACCESSORY				
330-9371	Universal Parking Brake Cable Kit				

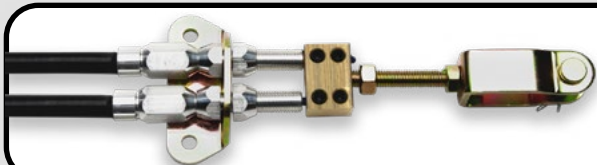

Parking Brake Cable Kit

(available separately)

P/N: [330-9371](#)

